

FAMOUSLY YOURS SCHOOL UNIFORM SURVIVAL GUIDE

1. ATTEND THE SCHOOL FITTING

WHAT IF I CAN'T COME ON THAT DAY? SHOP AT THE STORE THE WEEK PRIOR TO THE DATE OR CALL TO SET A TIME

2. PAY IN FULL AND RECEIVE 10% DISCOUNT

WHAT IF I CAN'T PAY IN FULL?

WE OFFER FREE LAYAWAY PLUS ACCEPT MC VISA AND DISCOVER

3. GARMENTS ARE GUARANTEED FOR A FULL SCHOOL YEAR

WHAT ABOUT PANT'S KNEES?

BUY THREE PAIR (SAME SIZE) AT THE FITTING KNEES ARE GUARANTEED

SIZE EXCHANGES AVAILABLE AT PICKUP

4. SCHOOL RECEIVES 5% BACK FROM YOUR ORDER

WHAT IS IT USED FOR?

ANYTHING THE SCHOOL CHOOSES

5. YOUR ORDER IS DELIVERED TO SCHOOL

WHAT IF I CAN'T BE THERE ON THAT DAY? PAID IN FULL ORDERS ARE LEFT AT SCHOOL

***JUST THINK A STRESS FREE AUGUST IN FIVE EASY STEPS
CIRCLE YOUR CALENDAR BECAUSE YOUR
UNIFORM DAY IS AT***

ST. PETER & PAUL CATHOLIC SCHOOL

FRIDAY, MAY 9, 2008

3:00 TO 5:30 P.M.



9981 LIN FERRY
ST. LOUIS, MO. 63123
314-842-4424
1-866-742-4424
FAMOUSLYOURS.COM

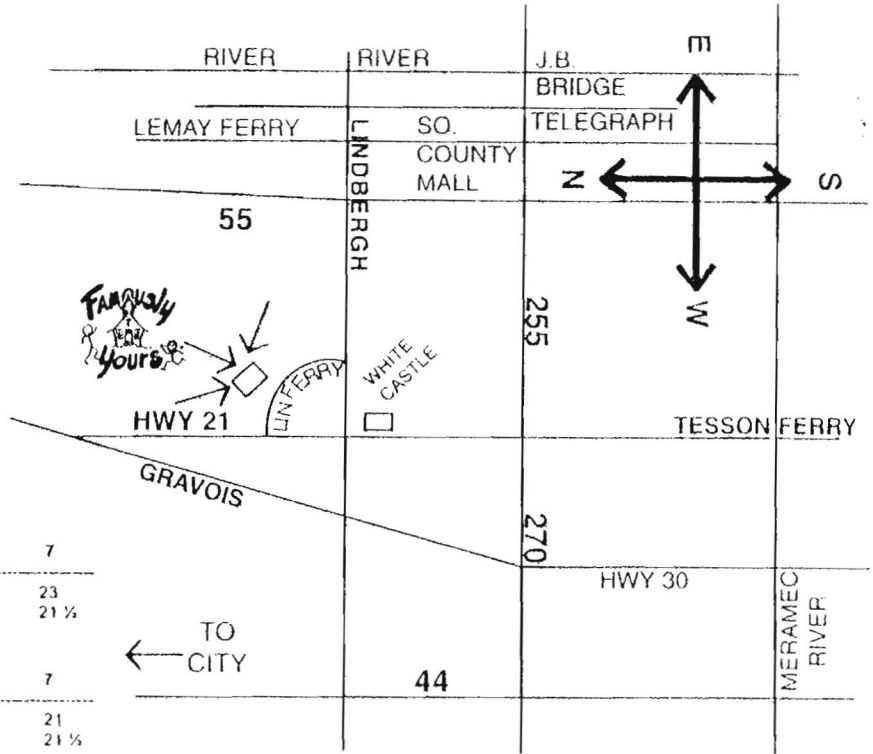

PANTS:

| | | | | | | | | | | | | | |
|----------------------------|--|---|--------|--------|--------|--------|----|----|----|----|----|----|----|
| 3-7 REGULAR SIZE - | | 3 | 4 | 5 | 6 | 7 | | | | | | | |
| WAIST | | 21 | 21 1/2 | 22 | 22 1/2 | 23 | | | | | | | |
| INSEAM | | 13 1/4 | 15 | 17 1/4 | 20 1/4 | 21 1/4 | | | | | | | |
| 3-7 SLIM SIZE - | | 3 | 4 | 5 | 6 | 7 | | | | | | | |
| WAIST | | 19 | 19 1/2 | 20 | 20 1/2 | 21 | | | | | | | |
| INSEAM | | 13 1/4 | 15 | 17 1/4 | 20 1/4 | 21 1/4 | | | | | | | |
| 8-16 REGULAR SIZE - | | 8 | 9 | 10 | 11 | 12 | 14 | 16 | | | | | |
| WAIST | | 24 | 24 1/2 | 25 | 25 1/2 | 26 | 27 | 28 | | | | | |
| INSEAM | | 22 | 23 1/4 | 25 | 26 | 27 | 28 | 29 | | | | | |
| 8-16 SLIM SIZE - | | 8 | 9 | 10 | 11 | 12 | 14 | 16 | | | | | |
| WAIST | | 22 | 22 1/2 | 23 | 23 1/2 | 24 | 25 | 26 | | | | | |
| INSEAM | | 22 | 23 1/4 | 25 | 26 | 27 | 28 | 29 | | | | | |
| 25-38 HUSKY - | | 25 | 26 | 27 | 28 | 29 | 30 | 31 | 32 | 33 | 34 | 36 | 38 |
| INSEAM | | 20 | 21 | 22 | 25 | 26 | 27 | 27 | 28 | 29 | 29 | 31 | 32 |
| 26-30 PREP - | | 26 | 27 | 28 | 29 | 30 | | | | | | | |
| INSEAM | | DIMENSION. 30" HEMMED, 32" HEMMED, 37" HEMMED | | | | | | | | | | | |
| 30-48 MENS - | | 30 | 31 | 32 | 33 | 34 | 36 | 38 | 40 | 42 | 44 | 46 | 48 |
| INSEAM | | DIMENSION 30" HEMMED, 32" HEMMED, 37" HEMMED | | | | | | | | | | | |

PLEASE
CALL FOR STORE HOURS
IN APRIL & MAY
BECAUSE OF SCHOOL
FITTINGS OUR HOURS ARE
NOT ALWAYS THE SAME

**HOW TO GET YOUR CHILD'S
CORRECT SIZE.**

HEIGHT:

Child should stand in stocking feet, with feet together back to a wall. Measure from floor to crown of head

CHEST:

Measure around fullest part of chest, keeping tape up under arms and around shoulder blades

WAIST:

Measure around waist (not over pants), at the height your child normally wears his or her pants. Keep one finger between tape and body

SEAT/HIPS:

Stand child with heels together, and measure around fullest part

INSEAM:

Using pants that fit well in length, measure from crotch seam to bottom of pant leg
Number of inches (to nearest 1/4") = inseam length

SIZING QUESTIONS?

CALL 842-4424 ONE OF OUR FITTERS
WILL BE GLAD TO ASSIST YOU

| GIRLS-JUMPERS/SKIRTS | 1 | 4 | 6 | 8 | 10 | 12 | 14 | 16 |
|--------------------------|--------|--------|--------|--------|--------|--------|--------|--------|
| REGULAR SIZE | | | | | | | | |
| waist | 20 | 21 | 22 | 23 | 24 | 24 | 24 1/2 | 25 1/2 |
| hips | 26 1/2 | 27 1/2 | 28 1/2 | 29 1/2 | 30 1/2 | 30 1/2 | 31 1/2 | 32 1/2 |
| skirt length | 12 | 13 | 14 | 15 | 16 | 17 | 18 1/2 | 19 1/2 |
| neck to waist | 9 | 9 1/2 | 10 | 10 1/2 | 11 | 11 1/2 | 12 | 13 |
| full length | 21 | 22 1/2 | 24 | 25 1/2 | 27 | 28 1/2 | 30 1/2 | 32 1/2 |
| bust | 24 | 25 | 26 | 27 | 27 1/2 | 28 | 29 | 30 |
| HALF SIZE | | | | | | | | |
| waist | 7 1/2 | 8 1/2 | 10 1/2 | 12 1/2 | 14 1/2 | 16 1/2 | 18 1/2 | |
| hips | 28 1/2 | 29 1/2 | 30 1/2 | 32 | 33 1/2 | 35 1/2 | 36 1/2 | |
| skirt length | 17 | 18 1/2 | 19 1/2 | 20 | 20 1/2 | 21 | 21 1/2 | |
| neck to waist | 11 1/2 | 12 | 13 | 13 1/2 | 14 1/2 | 15 | 16 1/2 | |
| full length | 26 1/2 | 30 1/2 | 32 1/2 | 33 1/2 | 36 | 36 | 37 | |
| bust | 32 | 33 | 34 | 36 1/2 | 37 | 38 1/2 | 40 | |
| TEEN-REGULAR SIZE | | | | | | | | |
| waist | 27 | 41 | 41 | 47 | 57 | 67 | 77 | 87 |
| hips | 31 | 32 | 33 | 34 | 35 1/2 | 37 | 38 1/2 | 40 |
| skirt length | 22 | 22 | 22 | 22 | 22 | 22 | 22 | 22 |
| neck to waist | 14 1/2 | 14 1/2 | 16 | 16 | 15 1/2 | 16 1/2 | 16 | 16 |
| full length | 36 1/2 | 36 1/2 | 37 | 37 | 37 1/2 | 37 1/2 | 38 | 38 1/2 |
| bust | 31 | 32 | 33 | 34 | 35 | 36 | 37 1/2 | 39 |
| TEEN-HALF SIZE | | | | | | | | |
| waist | 31 1/2 | 33 | 34 1/2 | 36 | 37 1/2 | 39 1/2 | 41 1/2 | |
| hips | 42 1/2 | 44 | 45 1/2 | 47 | 48 1/2 | 50 | 51 1/2 | |
| skirt length | 25 | 26 | 26 | 26 | 26 | 26 | 26 | |
| neck to waist | 16 1/2 | 16 1/2 | 16 1/2 | 16 | 16 | 16 1/2 | 16 1/2 | |
| full length | 40 1/2 | 40 1/2 | 40 1/2 | 41 | 41 | 41 1/2 | 41 1/2 | |
| bust | 40 | 40 1/2 | 43 | 44 1/2 | 46 1/2 | 48 | 50 | |

FAMOUSLY YOURS UNIFORMS 2008 PRICE LIST 10% AT SCHOOL FITTING ONLY

S.S.PETER & PAUL CATHOLIC SCHOOL WATERLOO, IL.

JUMPER ALL STYLES #55 PLAID

| | PRICE | 10% |
|--------|-------|-------|
| 3-18 | 37.00 | 33.30 |
| 7+/18+ | 39.00 | 35.10 |
| TEEN | 39.00 | 35.10 |
| TEEN + | 45.00 | 40.50 |

SKIRT ALL STYLES #55 PLAID

| | PRICE | 10% |
|--|-------|-------|
| | 33.00 | 29.70 |
| | 35.00 | 31.50 |
| | 35.00 | 31.50 |
| | 41.00 | 36.90 |

SCOOTER

| | PRICE | 10% |
|--|-------|-------|
| | 35.00 | 29.70 |
| | 37.00 | 31.50 |
| | 37.00 | 31.50 |
| | 42.00 | 36.00 |

CULOTTE

| | PRICE | 10% |
|--------|-------|-------|
| 3-18 | 34.00 | 30.60 |
| 7+/18+ | 36.00 | 32.40 |
| TEEN | 36.00 | 32.40 |
| TEEN+ | 42.00 | 37.80 |

SKORT

| | PRICE | 10% |
|--|-------|-------|
| | 31.00 | 27.90 |
| | 33.00 | 29.70 |
| | 33.00 | 29.70 |
| | 38.00 | 34.20 |

BROADCLOTH BLOUSE

| | SHORT | | LONG | |
|-------|-------|-------|-------|-------|
| | PRICE | 10% | PRICE | 10% |
| 5-16 | 11.50 | 10.35 | 14.50 | 13.05 |
| XS-XL | 14.50 | 13.05 | 16.50 | 14.85 |

OXFORD BLOUSE

| | SHORT | | LONG | |
|-------|-------|-------|-------|-------|
| | PRICE | 10% | PRICE | 10% |
| 7-16 | 15.50 | 13.95 | 17.50 | 15.75 |
| XS-XL | 19.50 | 17.55 | 21.50 | 19.35 |
| 2X-3X | 21.50 | 19.35 | 23.50 | 21.15 |

KNIT POLO PIQUE OR JERSEY KNIT /WHITE OR GREEN

ROUND COLLAR PIQUE

| | SHORT | | LONG | |
|--------|-------|-------|-------|-------|
| | PRICE | 10% | PRICE | 10% |
| YXS-XL | 15.00 | 13.50 | 17.50 | 15.75 |
| AS-XL | 18.00 | 16.20 | 20.50 | 18.45 |
| 2X-3X | 19.50 | 17.55 | 21.50 | 19.35 |

SLACKS OR CAPRIS NAVY

| | FLAT FRONT OR PLEATED | |
|----------------------------|-----------------------|-------|
| | PRICE | 10% |
| 4-6X ELASTIC | 20.00 | 18.00 |
| 7-16 REG/SLIM ELASTIC /OPT | 23.00 | 20.70 |
| 6+/18+ | 28.00 | 25.20 |
| JR 3-25 | 26.00 | 23.40 |
| JR PLUS | 29.00 | 26.10 |

WALK SHORTS NAVY

| | FLAT FRONT/PLEATED | |
|---------------------------|--------------------|-------|
| | PRICE | 10% |
| 4-6X ELASTIC | 18.00 | 16.20 |
| 7-16 REG/SLIM ELASTIC/OPT | 20.00 | 18.00 |
| 6+/18+ | 25.00 | 22.50 |
| JR3-25 | 23.00 | 20.70 |

UNISEX SWEATERS NAVY, GREEN OR WHITE

| GIRL CARDIGAN | | | LETTER CARDIGAN | | V/CREW PULLOVER | | VEST | |
|----------------------|------------|-------|------------------------|------------|------------------------|------------|--------------|------------|
| PRICE | 10% | | PRICE | 10% | PRICE | 10% | PRICE | 10% |
| XXS-XS | 22.00 | 19.80 | 25.00 | 22.50 | 19.50 | 17.55 | 18.50 | 16.65 |
| YS-YXL | 25.00 | 22.50 | 28.00 | 25.20 | 23.00 | 20.70 | 22.00 | 19.80 |
| AS-AXL | 32.00 | 28.80 | 34.00 | 30.60 | 28.00 | 25.20 | 27.00 | 24.30 |
| 2X-3XL | 34.00 | 30.60 | 37.00 | 33.30 | 33.00 | 29.70 | 32.00 | 28.80 |

BUY 3 OR MORE PR. 3.00 PER PAIR

| KNEE | | CREW | | 1/2 CREW | | NYLON TIGHTS | | CABLE TIGHTS | |
|--------------|------------|--------------|------------|-----------------|------------|---------------------|------------|---------------------|------------|
| PRICE | 10% | PRICE | 10% | PRICE | 10% | PRICE | 10% | PRICE | 10% |
| 3.50 | 3.15 | 3.25 | 2.93 | 3/9.00 | 8.10 | 5.00 | 4.50 | 10.00 | 9.00 |

BELTS

| MAGNETIC STRETCH | | WEB | | BRAIDED LEATHER | | REVERSIBLE LEATHER | |
|-------------------------|------------|--------------|------------|------------------------|------------|---------------------------|------------|
| PRICE | 10% | PRICE | 10% | PRICE | 10% | PRICE | 10% |
| 6.00 | 5.40 | 6.00 | 5.40 | 9.00 | 8.10 | 9.00 | 8.10 |

BOYS PANTS (REINFORCED KNEES)

NAVY

WALK SHORTS

| PULL ON | | | PLEATED /FLAT FRONT | | PULL ON | | PLEATED/FLAT FRONT | |
|----------------|------------|-------|----------------------------|------------|----------------|------------|---------------------------|------------|
| PRICE | 10% | | PRICE | 10% | PRICE | 10% | PRICE | 10% |
| 4-7 | 18.00 | 16.20 | 22.50 | 20.25 | 15.00 | 13.50 | 18.00 | 16.20 |
| 8-16 | REG/SLIM | | 25.50 | 22.95 | N/A | | 20.00 | 18.00 |
| 25-38 | HUSKY | | 30.00 | 27.00 | N/A | | 25.00 | 22.50 |
| 26-30 | PREP | | 30.00 | 27.00 | N/A | | 23.00 | 20.70 |
| 30-38 | MEN | | 32.00 | 28.80 | | | 23.00 | 20.70 |
| 40-48 | MEN | | 34.00 | 30.60 | | | 25.00 | 22.50 |

GYM CLOTHES 5-8 BLACK, RED, WHITE SHORTS ANT T SHIRT

| GYM SHIRT | | GYM SHORT NYLON/KNIT | | GYM SHORT MESH | | MESH LONG | | |
|------------------|------------|-----------------------------|------------|-----------------------|------------|------------------|------------|-------|
| PRICE | 10% | PRICE | 10% | PRICE | 10% | PRICE | 10% | |
| YOUTH | 10.00 | 9.00 | 9.00 | 8.10 | 11.00 | 9.90 | 14.00 | 12.60 |
| ADULT | 12.00 | 10.80 | 10.00 | 9.00 | 13.00 | 11.70 | 15.00 | 13.50 |

SWEATSHIRTS GREEN WITH SPPS LOGO

| | MONOGRAM | | TRANSFER | |
|-------|-----------------|------------|-----------------|------------|
| | PRICE | 10% | PRICE | 10% |
| YOUTH | 19.00 | 17.10 | 15.00 | 13.50 |
| ADULT | 20.00 | 18.00 | 16.00 | 14.40 |
| 2X-3X | 22.00 | 19.80 | 18.00 | 16.20 |